

P-Lindberg

Reserveteile

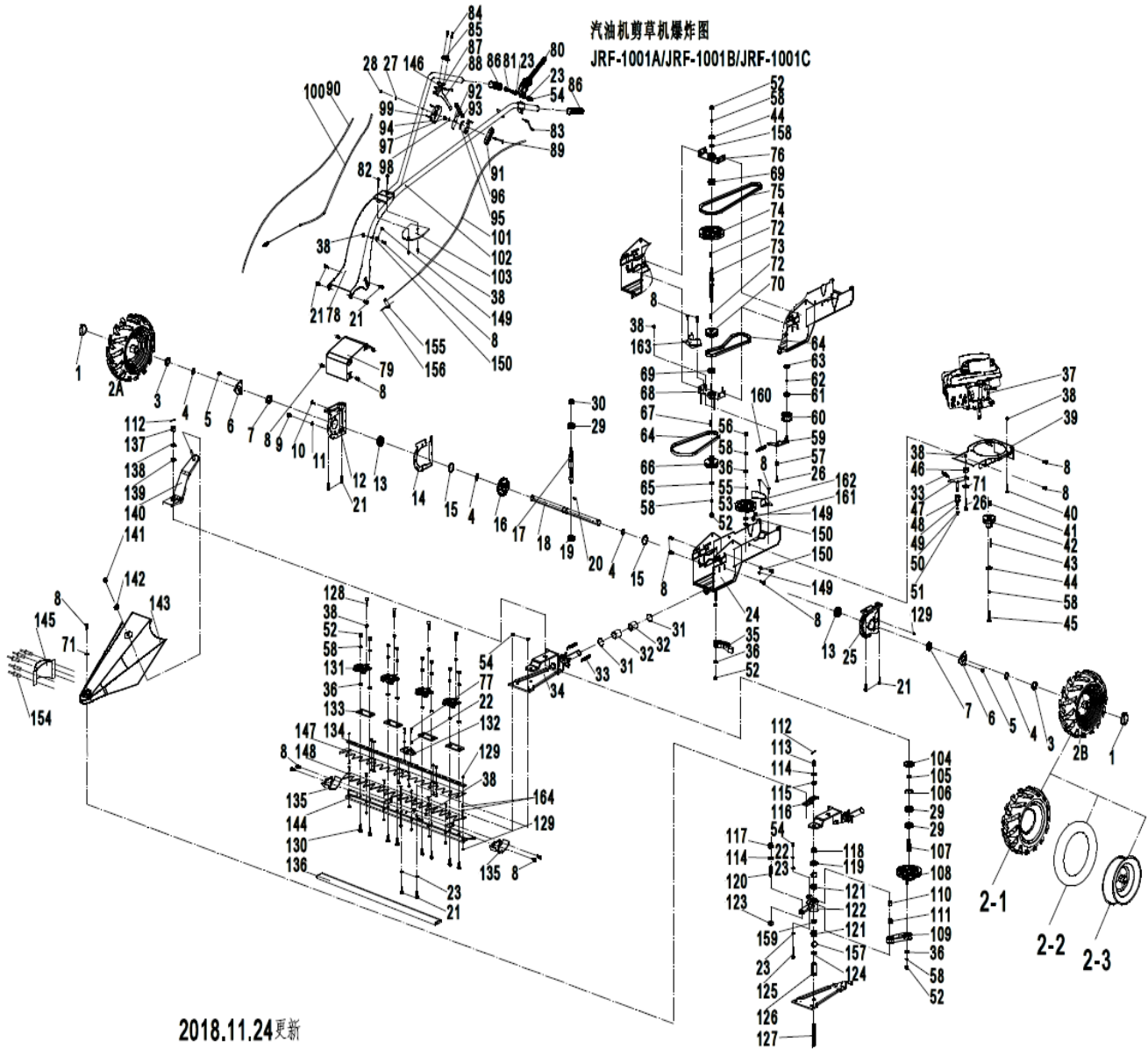

Fig 1:



Pos	Artikelnummer	Artikel	Description	Anzahl/Qty
2A	9060579	Rad rechts	Wheel right	1
2B	9060578	Rad links	Wheel Left	1
7	9025555	Dichtung	Oilseal	1
11	9050203	Unterlegscheibe M10	washer 10	1
13	9038552	Kugellager 6005	Bearing 6005	1
19	9038582	Kugellager 6302	Bearing 6302	1
23	9050202	Unterlegscheibe M8	washer 8	8
27	9050201	Unterlegscheibe M6	Washer 6	1
28	9050213	Kontermutter M6	Locknut 6	1
29	9038550	Kugellager 6004	Bearing 6004	3
30	9024630	Dichtung	Oilseal	1
32	9060798	Lager	Bearing	2
35	9060799	Spannarm	Tension arm	1
36	9050203	Unterlegscheibe M10	Washer 10	11
37		Motor	Engine	1
37-1	9060800	Seilzugstarter	Recoil start	1
37-2	9038938	Zündkerze	Sparkplug	1
38	9050214	Kontermutter M8	Locknut 8	16
47	9060801	Spannarm f. Antrieb	Clutch arm 2 assy	1
48	9060802	Spannarm f. Antrieb	Tension pulley	1
49	9060803	Kugellager f. Räder	Deep groove ball bearing	1
52	9050215	Kontermutter M10	Locknut 10	12
54	9050214	Kontermutter M8	Locknut 8	6
61	9027396	Kugellager 6200	Bearing 6200	1
64	9060561	Keilriemen 13x780	Belt 13X780	1
69	9038573	Kugellager 6203	Bearing 6203	2
75	9060562	Keilriemen 13x1060	Belt 13X1060	1
77	9060853	Bolen f. Antriebsstange	Screw f/sliding block	2
80	9060804	Kupplungshebel links	Clutch lever f/cutting	1
87	9060805	Halter f. Kupplungshebel	Clutch bar seat "down"	1
88	9060806	Kupplungshebel f. Antrieb	Clutch lever drive	1
90	9060807	Kupplungsseilantrieb	Clutch cable "drive"	1
92	9060808	Handgriff	Throttle lever	1
100	9060809	Gaskabel	Throttle cable	1
101	9060810	Kupplungsseilantrieb	Cutting clutch cable	1
107	9060811	Achse f. Riemenscheibe gross	Cutting big belt wheel shaft	1
109	9060812	Verbindungsstange f. Messer	Driving connection rod	1
110	9060855	Buchse f. Verb. Stange/Messer	Driving rod shaft bushing	1
111	9060813	Nadellager NK1520	Needle bearing NK1520	1

Pos	Artikelnummer	Artikel	Description	Anzahl/Qty
120	9062641	Bolzen M14 und Gleitblock	Sliding block screw	1
121	9060814	Nadellager NK2516	Cone needle bearing NK2516	2
122	9060815	Pleuelstange / Messerantrieb	Driven connect rod assy	1
123	9062641	Bolzen M14 und Gleitblock	Sliding block	1
131	9060816	Messerhalter	Blade fixing board	4
133	9060817	Einstellungsplatte	Adjusterplate	4
147	9060563	Messersatz oben/unten	Bladeset- Up/Down	1
148	9060563	Messersatz oben/unten	Bladeset- Up/Down	1